

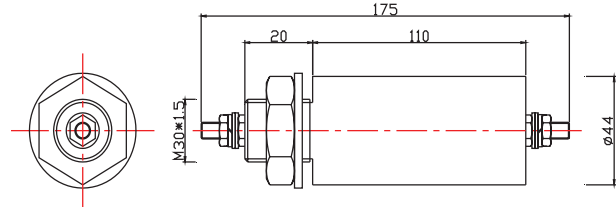

8060 - Feedthrough filters



Technical drawing



8060 series Feedthrough filters technical drawing with dimensions

8060 series Feedthrough filters

Used for EMI suppression of all electrical installations and equipment.

Technology

- Self-healing plastic film non inductive capacitor
- Tinned metal case
- Feed through mounting
- Flame retardant V0

Mounting

These filters are designed to be mounted directly in the entry panel of a Faraday cage or in an shielded filter housing. Please contact us for options.

Torgue value max.

- \varnothing M 27 : 40 Nm
- \varnothing M 32 : 40 Nm

Connection

Treaded terminals with nut:

- \varnothing M 4 : 1.2 Nm
- \varnothing M 6 : 2.45 Nm
- \varnothing M 8 : 10 Nm
- \varnothing M 10 : 15 Nm
- \varnothing M 12 : 20 Nm

Product part numbers

Part number	IR (A)	Screw	Insertion loss (dB)
8060-32	32	M6	
8060-63	63	M6	100dB, 1M-40GHz
8060-100	100	M6	

These values are measured under laboratory conditions. In your situation, results may differ. Please read our Guarantee.

How to order

When you want to order the 8060 please specify the following.

Series	Rated current (A)
8060	32
	32: 32 ampere
	63: 63 ampere
	100: 100 ampere